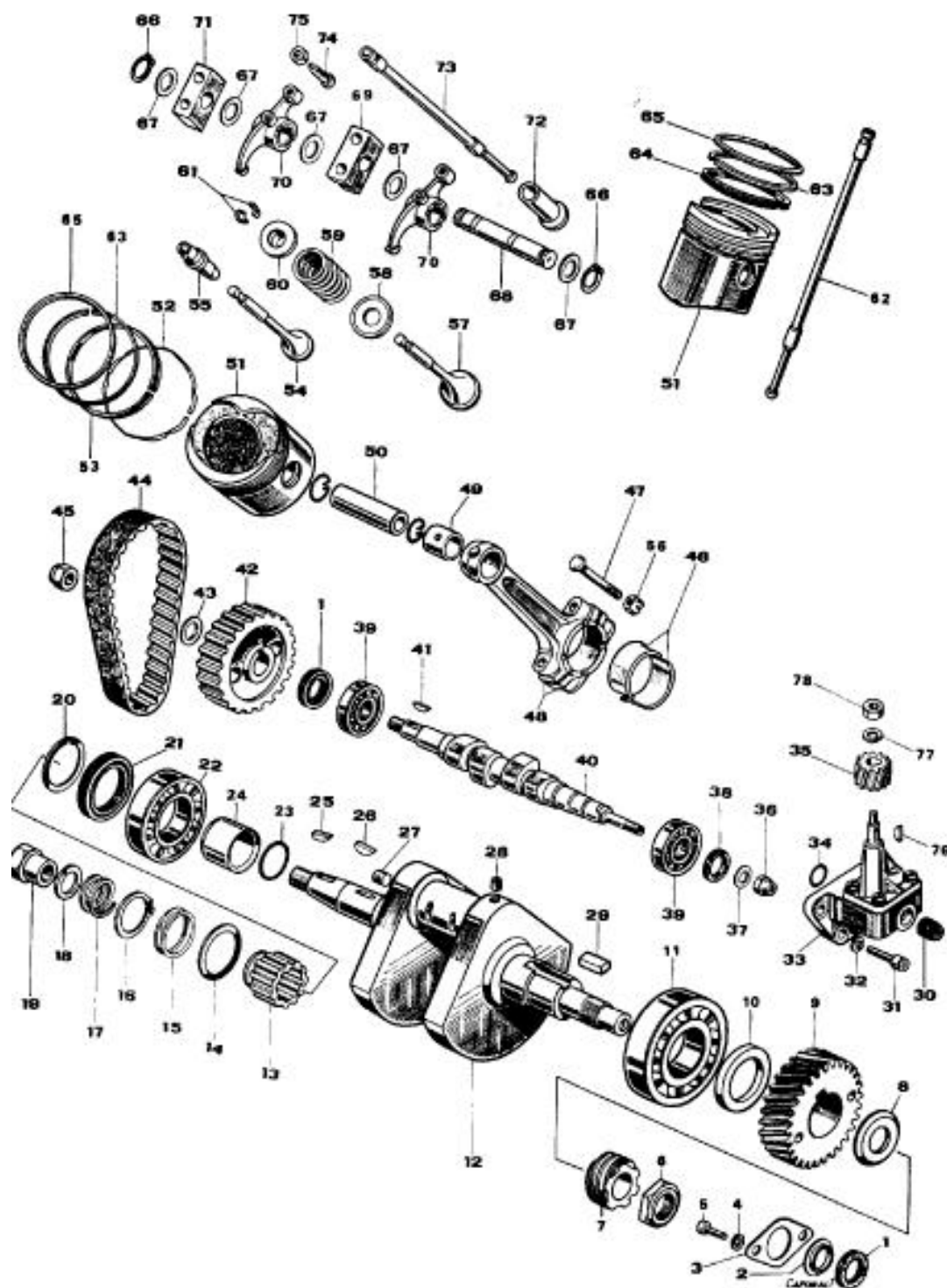

Table 3A: Crankshaft, Cam, Valves, etc**TAVOLA N. 3 A - TABLE No. 3 A**

No.	Code	Denominazione	Description
1	23.01.10	Anello SM 15247	Ring - SM 15247
2	15.05.07	Anello sostegno	Supporting ring
3	15.05.06	Piastrina	Plate
4	47.07.02	Rondella $\phi 5 \times 11$ VT. 701	Washer $\phi 5 \times 11$ VT. 701
5	47.02.19	Vite TC $\phi 5 \times 16$ VT. 228	Screw - TC - $\phi 5 \times 16$ VT. 228
6	47.03.01	Dado $\phi 18 \times 8,4$ 173.3029	Nut - $\phi 18 \times 8,4$ 173.3029
7	14.04.02	Vita senza fine (GP.)	Worm screw
8	13.04.03	Rondella ing. motor.	Washer - engine gear
9	14.04.01	Pignone motore	Pinion - engine
10	14.05.09	Distanziale	Spacer
11	24.01.10	Cuscinetto 6306 30.72.19	Bearing - 6306 30.72.19
12	12.04.01	Albero motore	Driving shaft
13	19.01.09	Roochetto corn. distrib.	Sprocket - timing gear
14	15.05.04	Rondella esterna	Washer - outer
15	22.01.44	Molla	Spring
16	27.01.09	Anello Seeger A $27 \times 1,2$	Seeger ring - A $27 \times 1,2$
17	22.01.37	Molla	Spring
18	47.08.09	Rondella EL $\phi 14$	Washer - EL $\phi 14$
19	47.03.23	Dado $\phi 14 \times 17$ VT. 327	Nut - $\phi 14 \times 17$ VT. 327
20	15.05.03	Rondella Interna	Washer - inner
21	23.01.12	Anello SM 30407	Ring - SM 30407
22	24.01.09	Cuscinetto 6206 30.62.16	Bearing - 6206 30.62.16
23	23.02.15	Anello OR 2067	OR Ring 2087
24	14.04.03	Boccola cuscinetto	Bush - bearing
25	28.01.16	Chiavetta 3×5 R 6,5 (Albero motore)	Key - 3×5 R 6.5
26	28.01.15	Chiavetta $3 \times 6,5$ R 8 (Albero motore)	Key . 3×6.5 R 8
27	26.01.09	Tappo $\phi 12 \times 1,5$ M.	Plug. $\phi 12 \times 1,5$ M.
28	26.01.06	Tappo $\phi 8 \times 1$ M.	Plug - $\phi 8 \times 1$ M.
29	28.01.13	Chiavetta $8 \times 7 \times 20$ (Pignone motore)	Key - $8 \times 7 \times 20$
30	23.02.18	Anello raccordo pompa	Pump connecting ring
31	47.06.05	Vite TCCE $\phi 6 \times 20$ VT. 604	Screw - TCCE - $\phi 6 \times 20$ VT. 604
32	47.06.03	Rondella elastica $\phi 6$	Spring washer - $\phi 6$
33	19.01.02	Pompa olio (senza ingranaggio elicoidale)	Oil pump
34	23.02.13	Anello OR 114	OR Ring 114
35	14.06.09	Ingranaggio elicoidale pompa	Helical gear - pump
36	47.03.20	Dado autobloccante $\phi 7 \times 8,8$ VT. 322	Self-locking nut $\phi 7 \times 8,8$ VT. 322
37	47.07.06	Scodellino	Cup
38	23.01.11	Anello SMIM 13.265	Ring - SMIM - 13.265
39	24.01.05	Cuscinetti 6202 15.35.11	Bearing -6202 15.35.11
40	12.04.03	Asse a camma	Cam shaft
41	28.01.14	Chiavetta 4×5 R 6,5 (Albero camma)	Key - 4×5 R 6,5
42	12.04.04	Puleggia condotta	Driven pulley
43	47.07.09	Rondella $\phi 10 \times 21$ VT. 709	Washer - $\phi 10 \times 21$ VT. 709
44	29.01.07	Cinghia distribuzione	Belt - timing gear
45	47.03.27	Dada $\phi 10 \times 9,1$ VT. 331	Nut - $\phi 10 \times 9,1$ VT. 331
46	25.03.07	Semicuscinetti 22527	Half-bearings 22527
47	47.01.56	Tirante	Tie rod
48	12.04.02	Biella	connecting rod
49	25.03.06	Boccola spinoff	Bush - piston pin
50	19.01.16	Spinotto pistons	Piston pin

continued on next page

<i>continued from previous page</i>			
No.	Code	Denominazione	Description
51	17.01.08	Pistone	Piston
52	17.02.29	Molletta (cil. ant.)	Spring
53	17.02.27	Segmento ROF (cil. ant.)	Piston ring - ROF
54	16.01.06	Valvola scarico	Exhaust valve
55	16.02.19	Boccola guida valvola	Valve guide bushing
56	47.03.31	Dado $\phi 8 \times 1 \times 8$ VT.334	Nut - $\phi 8 \times 1 \times 8$ VT.334
57	16.01.07	Valvola aspirazione	Intake valve
58	15.05.02	Scodellino	Valve spring retainer
59	22.01.47	Molla valvola	Spring - valve
60	14.04.04	Piattello valvola	Keeper valve
61	13.04.06	Semiconi valvola	Semiconic seat - valve
62	14.06.05	Asta punteria posteriore	Stem - tappet - rear
	13.04.05		
	13.04.07		
63	17.02.23	Segmento ROS	Ring - ROS - piston
64	17.02.25	Segmento ROF (cil. post.)	Ring - ROF - piston
65	17.02.21	Segmento ACK	Ring - ACK - piston
66	19.01.06	Anello Seeger $\phi 12$	Seeger ring $\phi 12$
67	19.01.07	Rondella	Washer
68	19.01.06	Spinotto bilancieri	Pivot Rocker arms
69	19.01.04	Supporto bilancieri tagliato	Split holder - rocker arms
70	19.01.03	Bilanciere	Rocker arm
71	19.01.05	Supporto bilanciere	Holder - rocker arm
72	14.04.05	Punteria	Tappet
73	14.06.06	Asta punteria anteriore	Stem - tappet - front
	13.04.05		
	13.04.07		
74	13.04.04	Registro punteria	Adjuster - tappet
75	47.03.26	Dado $\phi 6 \times 0,75 \times 5$ VT.330	Nut $\phi 6 \times 0,75 \times 5$ VT. 330
76	28.01.20	Chiavetta $2 \times 3,7$ R.10 (Ingr. pomp.)	Key 2×3.7 R.10
77	47.08.05	Rondella elastica $\phi 8$	Spring washer - $\phi 8$
78	47.03.34	Dado $\phi 8 \times 1 \times 8$	Nut - $\phi 8 \times 1 \times 8$
	17.01.09	Pistone NORMALE maggiorato	Oversized Standard Piston
	17.01.10	Pistone SPORT	Sport Piston
	17.01.11	Pistone SPORT maggiorato	Oversized Sport Piston
	17.02.22	Segmento ACK maggiorato	ACK Oversized Piston Ring
	17.02.24	Segmento ROS maggiorato	ROS Oversized Piston Ring
	17.02.26	Segmento ROF maggiorato	ROF Oversized Piston Ring
	17.02.28	Segmento ROF maggiorato	ROF Oversized Piston Ring