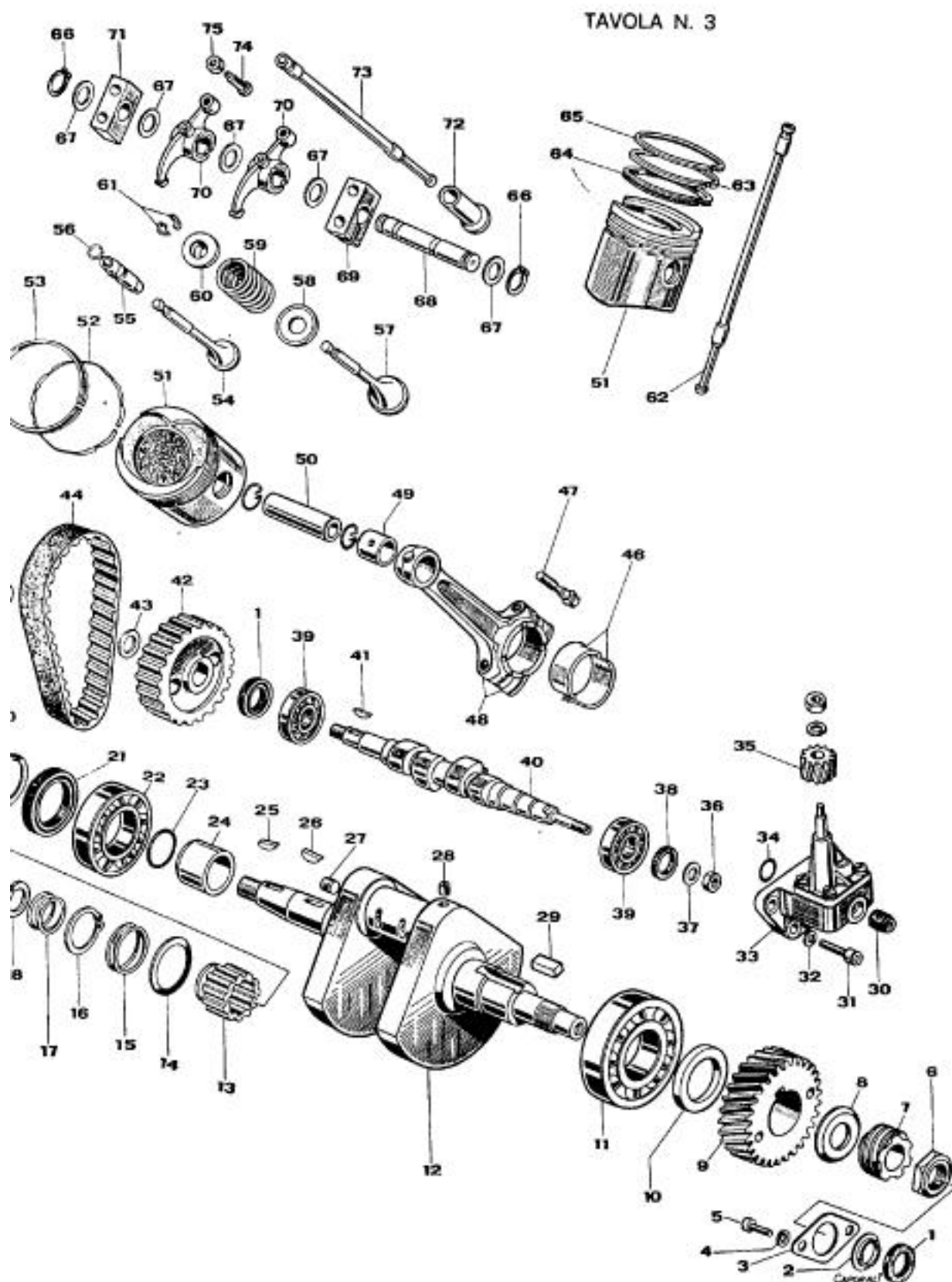

Table 3: Crankshaft, Cam, Valves, etc



No.	Code	Denominazione	Description
1	23.01.10	Anello SM 15247	Ring SM 15247
2	15.05.07	Anello sostegno	Supporting ring
3	15.05.06	Piastrina	Plate
4	47.07.02	Rondella $\phi 5 \times 11$	Washer $\phi 5 \times 11$
5	47.02.19	Vite TC $\phi 5 \times 16$	Screw TC $\phi 5 \times 16$
6	47.03.01	Dado $\phi 18 \times 8,4$	Nut $\phi 18 \times 8,4$
7	14.04.02	Vite senza fine	Worm
8	13.04.03	Rondella ing. motore	Washer - engine gear
9	14.04.01	Pignone motore	Pinion - engine
10	14.05.09	Distanziale	Spacer
11	24.01.10	Cuscinetto 6306	Bearing - 6306
12	12.04.01	Albero motore	Driving shaft
13	19.01.09	Rocchetto corn. distrib.	Sprocket - timing gear
14	15.05.04	Rondella esterna	Washer - outer
15	22.01.44	Molla	Spring
16	27.01.09	Seeger A $27 \times 1,2$	Circlip A $27 \times 1,2$
17	22.01.37	Molla	Spring
18	47.08.10	Rondella AZ $\phi 18$	Washer AZ $\phi 18$
19	47.03.23	Dado $\phi 14 \times 17$	Nut $\phi 14 \times 17$
20	15.05.03	Rondella interna	Washer - inner
21	23.01.12	Anello SM 30407	Ring - SM 30407
22	24.01.09	Cuscinetto 6206	Bearing - 6206
23	23.02.15	OR 2087	OR 2087
24	14.04.03	Boccola cuscinetto	Bush - bearing
25	28.01.16	Chiavetta 3×5 R 6,5	Key - 3×5 R 6.5
26	28.01.15	Chiavetta $3 \times 6,5$ R B	Key - 3×6.5 R 8
27	26.01.09	Tappo $\phi 12 \times 1,5$	Plug $\phi 12 \times 1,5$
28	26.01.08	Tappo $\phi 8 \times 1$	Plug $\phi 8 \times 1$
29	28.01.13	Chiavetta $\phi 8 \times 7 \times 20$	Key - $8 \times 7 \times 20$
30	23.02.18	Boccola pompa olio	Bush - oil pump
31	47.06.05	Vite TCCE $\phi 6 \times 20$	Screw - TCCE - $\phi 6 \times 20$
32	47.08.03	Rondella elastica $\phi 6$	Spring washer $\phi 6$
33	19.01.02	Pompa olio	Oil pump
34	23.02.13	OR 114	OR 114
35	14.06.09	Ingranaggia elicoidale pompa	Helical gear - pump
36	47.03.20	Dado $\phi 7 \times 8,8$	Nut - $\phi 7 \times 8,8$
37	47.07.06	Rondella $\phi 7 \times 14$	Washer - $\phi 7 \times 14$
38	23.01.11	Anello SMIM 13.265	Ring - SMIM - 13.265
39	24.01.05	Cuscinetto 6202	Bearing - 6202
40	12.04.03	Asse a camma	Cam shaft
41	28.01.14	Chiavetta 4×5 R 6,5	Key - 4×5 R 6.5
42	12.04.04	Puleggia condotta	Driven pulley
43	47.07.09	Rondella $\phi 10 \times 21$	Washer - $\phi 10 \times 21$
44	29.01.07	Cinghia distribuzione	Belt - timing gear
45	47.03.27	Dado $\phi 10 \times 9,1$	Nut $\phi 10 \times 9,1$
46	25.03.07	Semicuscinetti	Half-bearings
47	47.01.47	Vite TE testa biella	Screw - TE - big end
48	12.04.02	Biella	connecting rod
49	25.03.06	Boccola spinotto	Bush - piston pin
50	19.01.16	Spinotto pistone	Piston pin

continued on next page

<i>continued from previous page</i>			
No.	Code	Denominazione	Description
51	17.01.08	Pistone	Piston
52	17.02.29	Molletta	Spring
53	17.02.27	Segmento ROF	Piston ring - ROF
54	16.01.06	Valvola scarico	Exhaust valve
55	16.02.15	Guida	Guide
56	22.01.36	Anello guida valvola	Ring - valve guide
57	16.01.07	Valvola aspirazione	Intake valve
58	15.05.02	Scodellino	Valve spring retainer
59	22.01.47	Molla valvola	Spring - valve
60	14.04.04	Piattello	Keeper
61	13.04.06	Semiconi	Semiconic seat - valve
62	14.06.05	Asta punteria posteriore	Stem - tappet - rear
	13.04.05		
	13.04.07		
63	17.02.23	Segmento ROS	Ring - ROS - piston
64	17.02.25	Segmento ROF	Ring - ROF - piston
65	17.02.21	Segmento ACK	Ring - ACK - piston
66	19.01.08	Seeger	Seeger
67	19.01.07	Rondella	Washer
68	19.01.06	Spinotto bilancieri	Pivot - rocker-arms
69	19.01.04	Supporto bilancieri tagliato	Split holder - rocker arms
70	19.01.03	Bilanciere	Rocker arm
71	19.01.05	Supporto bilanciere	Holder - rocker arm
72	14.04.05	Punteria	Tappet
73	14.06.06	Asta punteria anteriore	Stem - tappet - front
	13.04.05		
	13.04.07		
74	13.04.04	Registro punteria	Adjuster - tappet
75	47.03.26	Dado 6× \varnothing 0,75×5	Nut 6×0,75×5