

Table 2A: Head, Cylinder, Rocker Cover, Rubber Intake Manifold

TESTA - CILINDRO - COPERCHIO TESTA - COLLETTORE ASPIR. - TAVOLA N. 2A
HEAD - CYLINDER - HEAD COVER - INTAKE MANIFOLD COUPLING - TABLE No. 2A

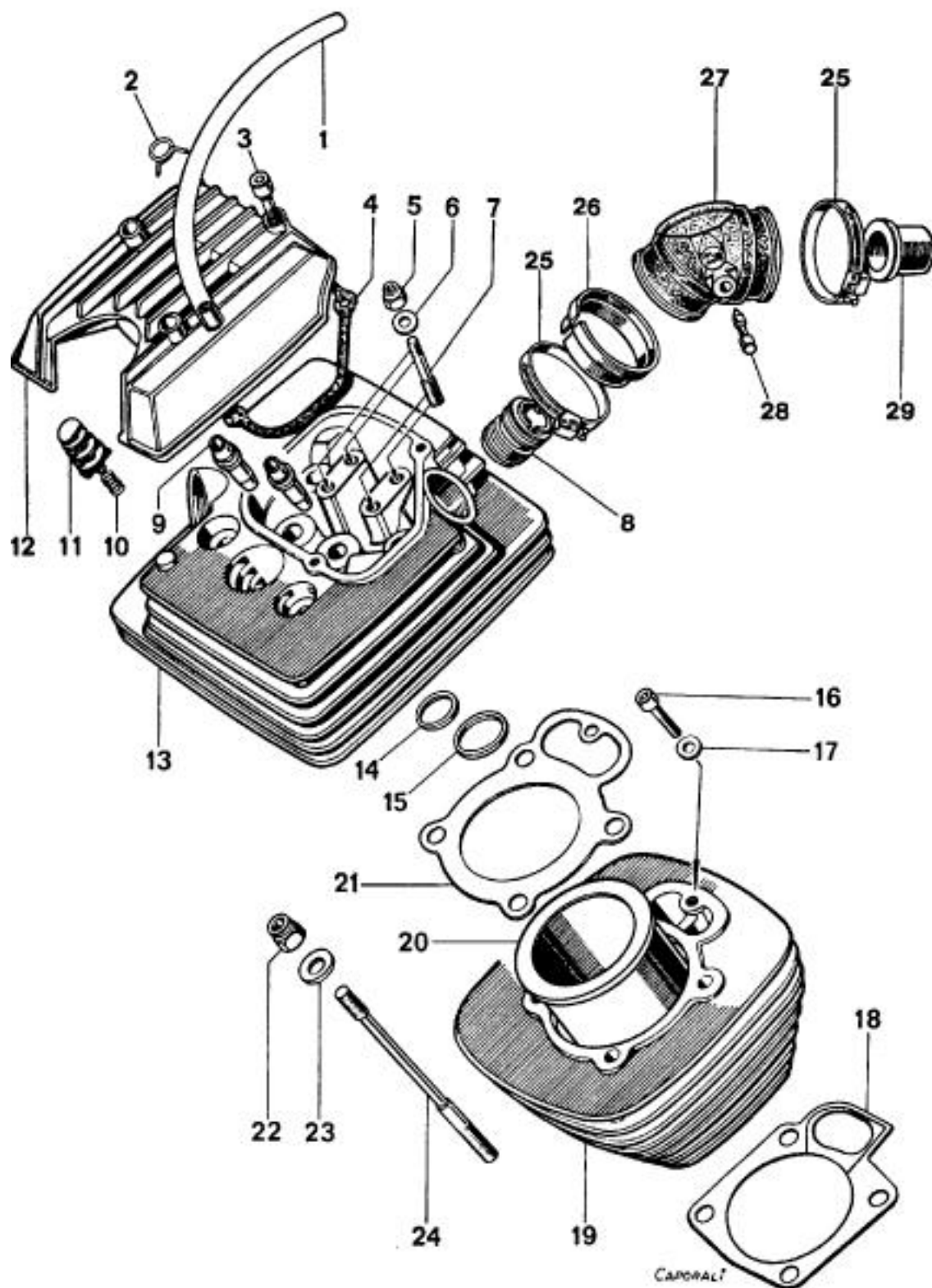

Table 2A

| No. | Code | Denominazione | Description |
|-----|----------|--|---------------------------------|
| 1 | 14.07.12 | Tuba efiato anteriore | Breather front pipe |
| 2 | 22.01.45 | Molla | Spring |
| 3 | 47.06.02 | Vite T.C.C.E. $\phi 6 \times 50$ VT. 601 | Cheese headed socket screw |
| 4 | 21.01.61 | Guarnizione coperchia testa | Head cover gasket |
| 5 | 47.03.20 | Dado autobloccante $\phi 7 \times 8,3$ VT. 322 | Self locking nut |
| 6 | 47.07.06 | Rondella plane $\phi 7 \times 14$ VT. 706 | Flat washer |
| 7 | 47.05.10 | Prigioniero bilancieri $\phi 8 \times 47$ VT. 521 | Rockers stud bolt |
| 8 | 13.04.39 | Ghiera collegamento manicotto aspirazione | Intake plug connection ring nut |
| 9 | 16.02.19 | Boccola guide valvola | Valve guide bushing |
| 10 | 22.01.39 | Molla ariato coperchia testa | Head cover breather spring |
| 11 | 11.03.13 | Sfiato coperchio testa | Head cover breather |
| 12 | 11.02.18 | Coperchio testa | Head cover |
| 13 | 10.01.11 | Testa nuda | Bare head |
| 14 | 16.02.07 | Sede valvola scarico | Exhaust valve seat |
| 15 | 16.02.08 | Sede valvola aspirazione | Intake valve seat |
| 16 | 47.06.01 | Vita T.C.C.E. $\phi 6 \times 35$ VT. 600 | Cheese headed socket screw |
| 17 | 47.07.03 | Rondella piana $\phi 6 \times 13$ VT. 702 | Flat washer |
| 18 | 21.01.59 | Guarnizione base cilindro | Cylinder base gasket |
| 19 | 10.01.12 | Cilindro | Cylinder |
| 20 | 10.01.13 | Canne cilindro | Cylinder liner |
| 21 | 21.01.60 | Guarnizione testa | Head gasket |
| 22 | 47.03.22 | Dado autobloccante $\phi 8 \times 10,4$ VT. 324 | Self locking nut |
| 23 | 13.04.16 | Rondella dadi testa | Head nuts washer |
| 24 | 47.05.09 | Prigioniero cilindro testa $\phi 9 \times 156$ VT. 520 | Cylinder head stud |
| 25 | 26.01.14 | Fascetta stringi tuba tipo B5 | Pipe clamp |
| 26 | 32.01.32 | Anello porta fascetta | Clamp holding ring |
| 27 | 30.01.55 | Manicotto collettore aspirazione | Intake manifold coupling |
| 28 | 13.04.43 | Tappo | Plug |
| 29 | 32.01.42 | Boccola | Bushing |