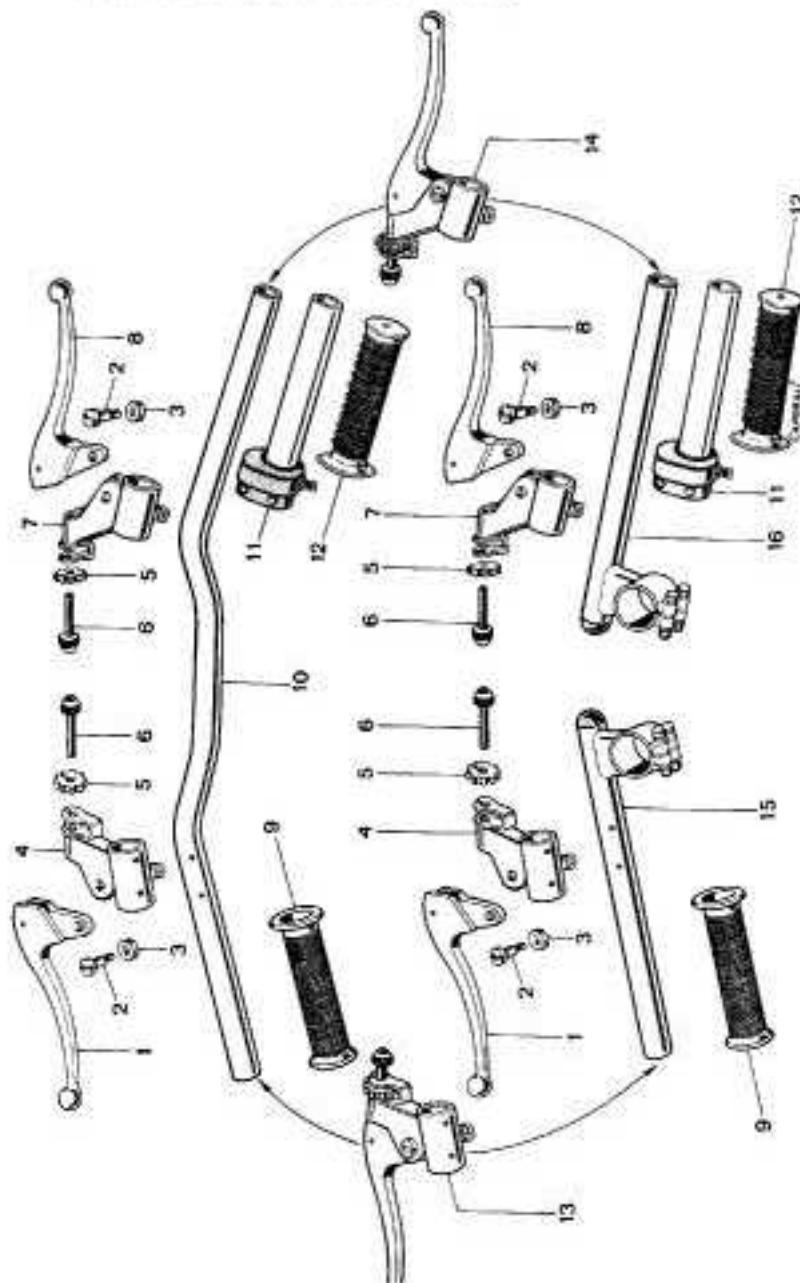

Table 20A: Handlebars (Drum brake)

MANUBRIO 350 NORMALE (con freno a tamburo)
STANDARD 350 Handle bar (with drum brake)

MANUBRIO 350 SPORT (con freno a tamburo)
SPORT 350 Handle bar with drum brake)

TAVOLA N. 20 A
TABLE No. 20 A



No.	Code	Denominazione	Description
1	41.02.17	Leva sinistra	Left-hand lever
2	41.02.06	Vite fissaggia leva	Lever securing screw
3	41.02.07	Dado fissaggia leva	Lever securing nut
4	41.02.30	Supporto orientabile sinistro nudo	Left-hand bar adjustable support
5	41.02.23	Rondella filettata registro trasmissione	Threaded washer for driving gear adj.
6	41.02.22	Registro trasmissione	Cable adjuster
7	41.02.29	Supporto orientabile destro nudo	Right-hand bar adjustable support
8	41.02.18	Leva destra	Right-hand lever
9	41.02.01	Manopola sinistra	Left-hand grip
10	41.01.14	Manubria nudo NORMALE	STANDARD bare handle bar
11	41.02.16	Comando gas nudo	Bare gas control
12	41.02.02	Manopola destra	Right-hand grip
13	41.02.20	Supporto orientabile sinistro completo	Complete adjustable left-hand support
14	41.02.19	Supporto orientabile destro completo	Complete adjustable right-hand support
15	41.01.15	Impugnatura sinistra nuda SPORT	SPORT bare left-hand grip
16	41.01.16	Impugnatura destra nuda SPORT	SPORT bare right-hand grip